

Pinnacle Academy and
George Mason University College of Science Present

Project:

49 In 114.82 Indium	102 No 289 Nobelium	23 V 50.942 Vanadium	85 At 210 Astatine	53 I 126.90 Iodine	8 O 15.999 Oxygen	7 N 14.007 Nitrogen
------------------------------	------------------------------	-------------------------------	-----------------------------	-----------------------------	----------------------------	------------------------------

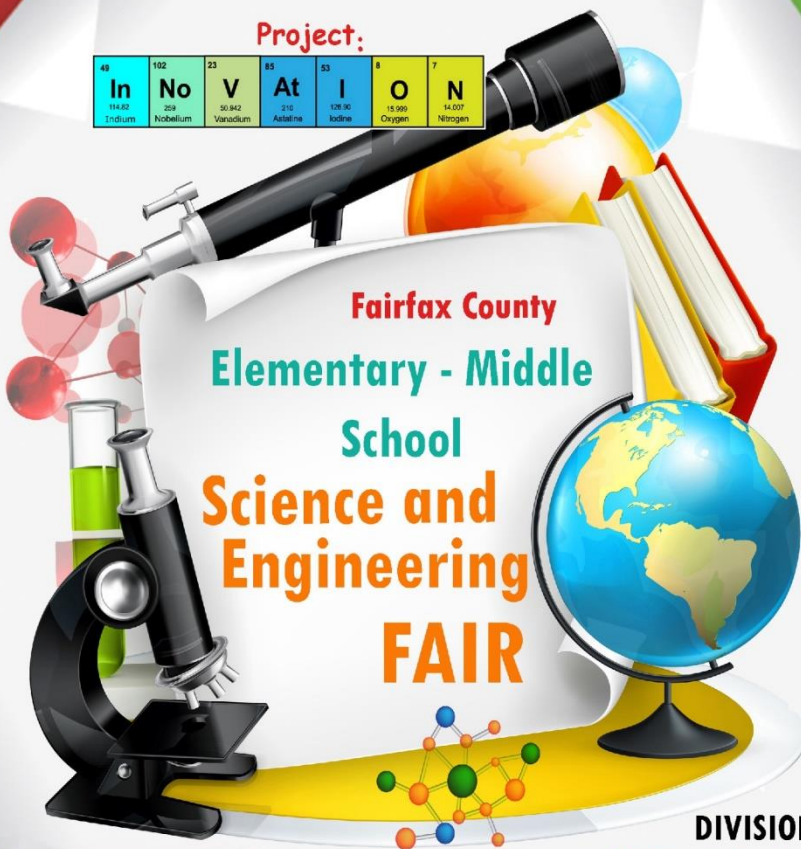

Saturday, May 7, 2016
at George Mason University

DIVISIONS

Division I. Grades 1-3
Division II. Grades 4-5
Division III. Grades 6-8

Please visit us for more information

www.fcsefair.com



Organizers:



Pinnacle Academy

Pinnacle Academy, a Math-and Science-focused school, immerses students into a multicultural learning environment that promotes critical thinking and problem solving and encourages students to apply this knowledge in real world situations.



The College of Science

The College of Science at GMU blends traditional science education with sought-after programs in molecular medicine, climate dynamics, planetary science, forensic science, environmental studies, and geo-information science to prepare students for exciting careers on the cutting edge of interdisciplinary scientific domains.

Schedule

Saturday, May 7, 2016 (The Hub)

TIME	ACTIVITY	LOCATION
9:00-9:30	Registration (Students and Parents)	Lobby
9:00-10:00	Judging Round-1 (Judges Only)	Meeting Rooms 1,2,3,4 and 5
9:30-10:00 (Chaperones Required)	Welcome and Opening Remarks to Students, Parents and Guests	Ballroom
10:15-11:45	Judging Round-2 (Students must be present)	Meeting Rooms 1,2,3,4 and 5
10:15-11:15	Parent Educational Session (Parents and Guests)	Ballroom
11:15-11:45	STEM Exhibits (Parents and Guests)	Ballroom
11:45-12:30 (Chaperones Required)	Lunch	
12:30-2:00 (Chaperones Required)	Public Viewing (This is the only time parents, teachers, and relatives are invited to see all displays.) *Students can also view STEM exhibits.	Meeting Rooms 1,2,3,4 and 5
2:00-3:00 (Chaperones Required)	Awards Ceremony	Ballroom
3:00-3:30	Display Removal (Any display not removed by 4:00 pm will be discarded.)	

OPENING CEREMONY

OPENING REMARKS

MCee Lamija Silajdzic

KEYNOTE SPEAKERS

GMU College of Science, Associate Dean of Research, Dr. Ali Andalibi

Pinnacle Academy Board Member, Dr. Mumtaz Hussain

Supervisor John Foust



AWARDS CEREMONY

KEYNOTE SPEAKERS

GMU College of Science STEM Accelerator Director, Dr. Padhu Seshaiyer

Supervisor John Cook

PRESENTATION OF Fairfax County Elementary & Middle School
Science & Engineering Fair AWARD WINNERS

PRESENTATION OF BroadCom MASTERS Nominees

PRESENTATION OF SPECIAL AWARD WINNERS

Washington DC Chapter of the American Meteorological Society (DC-AMS)

Simone Acha and Neel Gopalani, ECS Federal, LLC

*GMU Society of Industrial & Applied Mathematics and Association of Women in
Mathematics*

CLOSING REMARKS

MCee Lamija Silajdzic

MAP

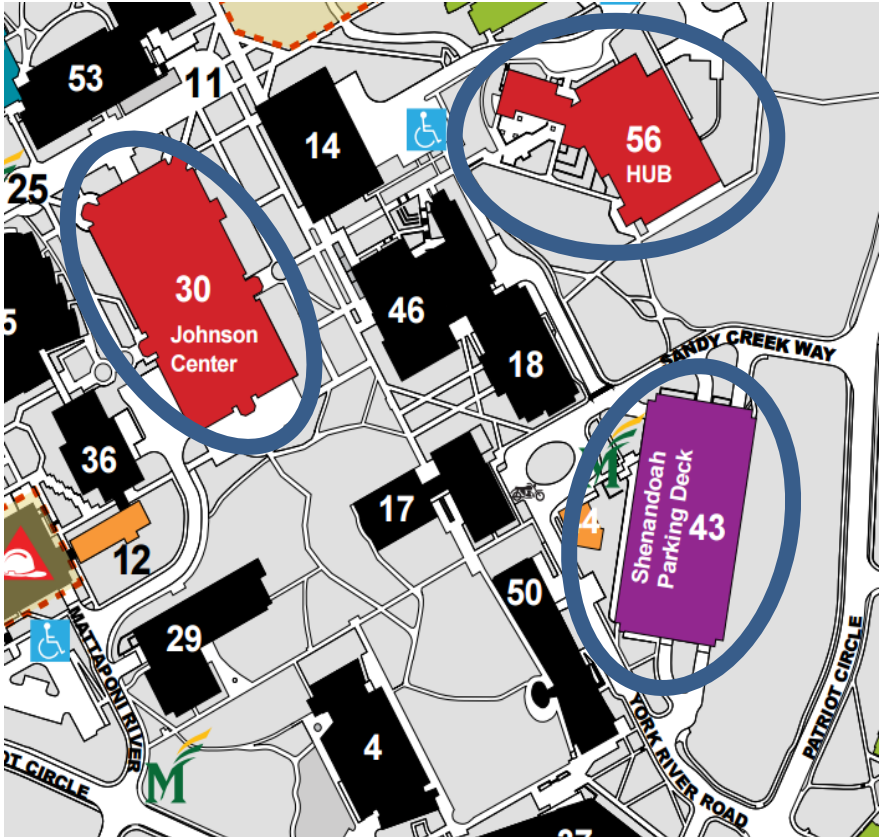

56 HUB: FCSE Fair

43 Shenandoah Parking Deck: Parking

30 Johnson Center: Lunch

Building 56, The Hub, Level III

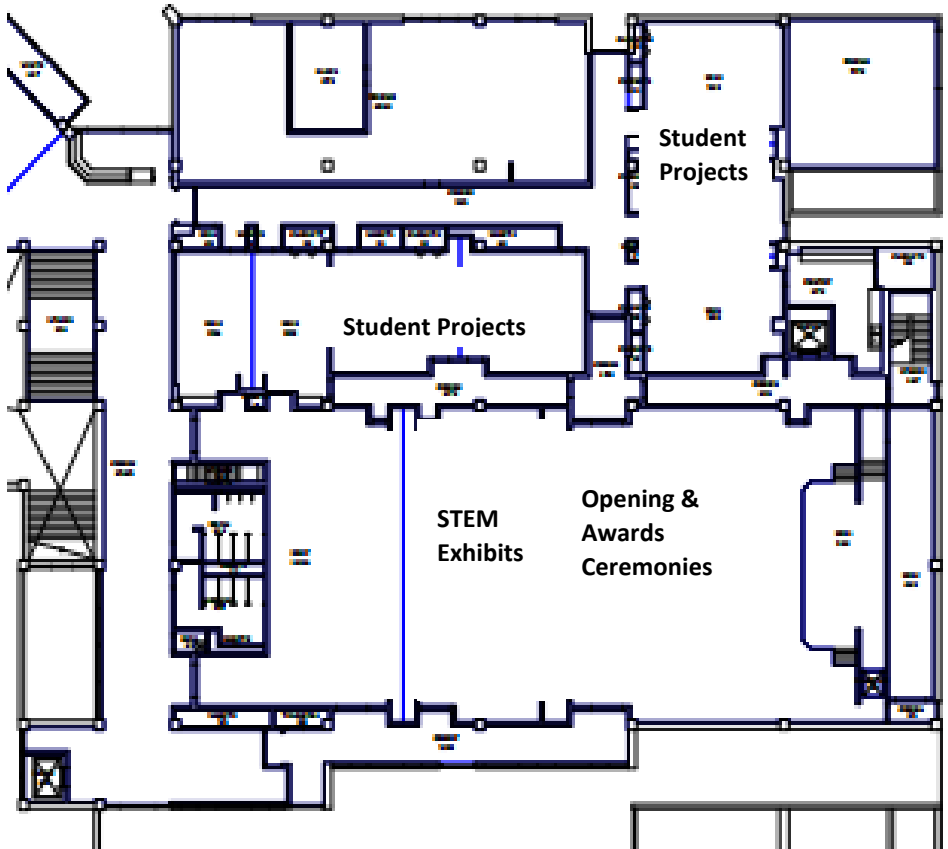

Participating Schools

Academy of Christian Education

Alexandria Country Day School

Edlin School

Green Hedges School

GreenBriar West Elementary School

Mantua Elementary School

Nysmith School for the Gifted

Pinnacle Academy

Shrevewood Elementary School

Washington International Academy

Woodley Hills Elementary School

The Langley School

Projects by Category

	Division I (Grades 1-3)	Division II (Grades 4-5)	Division III (Grades 6-8)
Life Science / Earth Science	17	8	28
Physical Science/ Engineering	17	17	24

Parent Information Session

- **Moderator:** Padhu Seshaiyer, GMU College of Science STEM Accelerator Director
- **Panel Speakers:**
 - Spencer Jameison, FCPS Elementary Math Specialist
 - Abbas Eftekhari, Dean of Mathematics, Science, and Engineering at NVCC
 - Kelly Knight, GMU Faculty Member, Forensic Sciences
 - Pradyuta Padmanabhan, High School Student

STEM Exhibits

- Drones and STEM, GMU
- Match Graph, GMU
- The STEM Accelerator Program, GMU
- BASIS Independent McLean
- Pinnacle Academy Robotics and Future City Clubs

Special Awards Organizations

- Washington DC Chapter of the American Meteorological Society (DC-AMS)
- ECS Federal, LLC
- GMU Society of Industrial & Applied Mathematics and Association of Women in Mathematics

Sponsors



Pinnacle Academy and
George Mason University College of Science Present

Project:

49 In 114.82 Indium	102 No 284 Nobelium	23 V 50.942 Vanadium	85 At 210 Astatine	53 I 126.90 Iodine	8 O 15.999 Oxygen	7 N 14.007 Nitrogen
------------------------------	------------------------------	-------------------------------	-----------------------------	-----------------------------	----------------------------	------------------------------



Fairfax County
Elementary - Middle
School
Science and
Engineering
FAIR

Saturday, May 7, 2016
at George Mason University

DIVISIONS

Division I. Grades 1-3
Division II. Grades 4-5
Division III. Grades 6-8

Please visit us for more information

www.fcsefair.com



College of Science

